

Gate Close, Borehamwood

£375,000 (Freehold)



Welcome to this charming terraced house located in the peaceful cul-de-sac of Gate Close, Borehamwood. This property boasts a spacious living room, good sized kitchen/breakfast room, two lovely bedrooms, and a well-maintained bathroom, providing the perfect space for comfortable living.

Conveniently located 1.3 miles from Elstree & Borehamwood train station with the High Street just 0.8 miles away. There are local shops just a 5 minute walk from the property giving complete convenience for its owners. The property is also perfectly placed for great road links with the A1 and M25 just a few minutes away.

One of the standout features of this property is its extension potential to the rear. Imagine the possibilities of creating your dream kitchen, a spacious dining area, or even a home office - the choice is yours to make this house truly your own.

020 3764 2222
www.village-estates.co.uk



Village Estates
The Corner Shop High Street, Elstree
Herts WD6 3BY

Important Note: These particulars do not form part of any contract. All measurements are approximate and should not be relied upon. All prices quoted are strictly subject to contract.





Approx Gross Internal Area
51 sq m / 552 sq ft

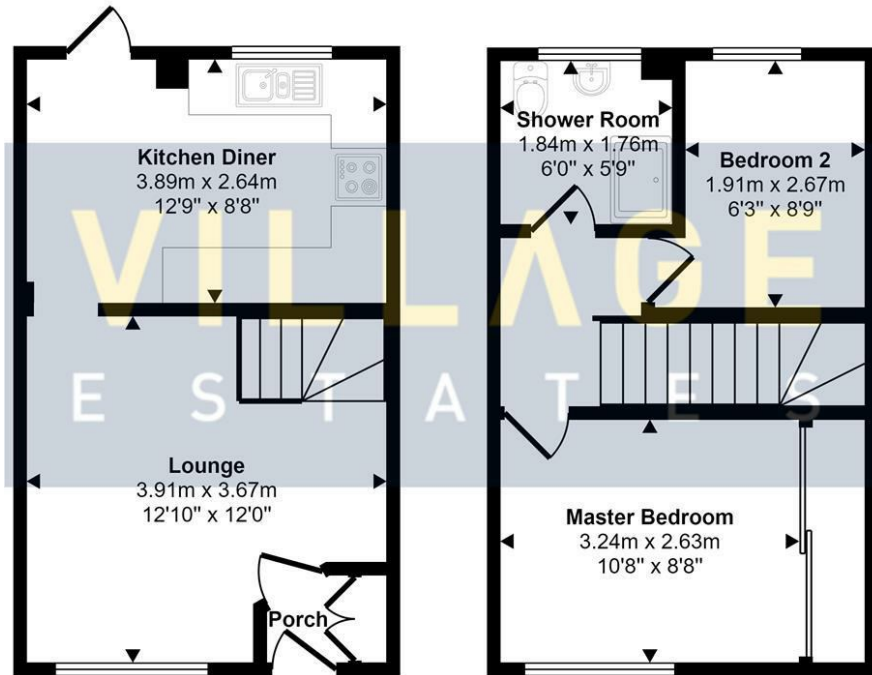

Ground Floor
Approx 26 sq m / 275 sq ft

First Floor
Approx 26 sq m / 276 sq ft

This floorplan is only for illustrative purposes and is not to scale. Measurements of rooms, doors, windows, and any items are approximate and no responsibility is taken for any error, omission or mis-statement. Icons of items such as bathroom suites are representations only and may not look like the real items. Made with Made Snappy 360.

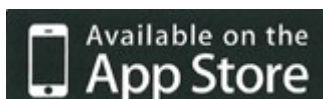

| Energy Efficiency Rating | | |
|---|---|-----------|
| | Current | Potential |
| Very energy efficient - lower running costs | | |
| (92 plus) A | | |
| (81-91) B | | |
| (69-80) C | | |
| (55-68) D | | |
| (39-54) E | | |
| (21-38) F | | |
| (1-20) G | | |
| Not energy efficient - higher running costs | | |
| England & Wales | EU Directive 2002/91/EC  | |